

Prime Brand New Harbour View Office For Lease

優質全新維港景辦公室單位出租

Stock Ref. No. OLK20181203L - 10 December 2018

savills
第一太平戴維斯

savills.com.hk

18 Hung Luen Road, Hunghom

China Life Center

中國人壽中心

紅磡紅鸞道18號

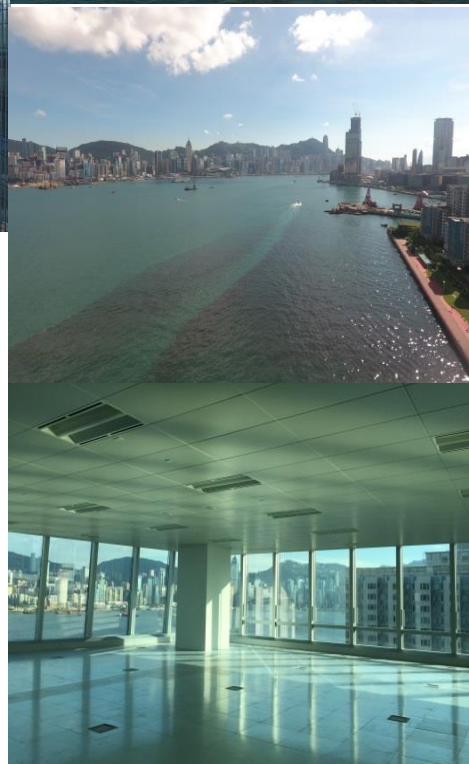

The Premises | 物業 Gross Area | 建築面積

Tower A (A座)

- ❖ G/F - 1/F (Retail) ❖ 9,000 - 16,000 sq.ft. 約 9,000 - 16,000 平方呎
- ❖ 2/F - 17/F (Office) ❖ 25,500 sq.ft. 約 25,500 平方呎

Tower B (B座) - Retail

- ❖ G/F & 1/F ❖ 18,000 sq.ft. 約 18,000 平方呎

Features | 物業特色

- ❖ Top-tier Grade A Office Building in the Core District of Hunghom
紅磡核心商業區著名甲級辦公大樓
- ❖ Panoramic View of the Victoria Harbour
盡享180度維港景致
- ❖ 5-minute walk to Whampoa MTR Station
步行五分鐘直達黃埔港鐵站
- ❖ Located right next to Kerry Hotel and Wonderful Worlds of Whampoa with variety of F&B and shops
毗鄰香港嘉里大酒店及黃埔新天地，飲食購物配套完善

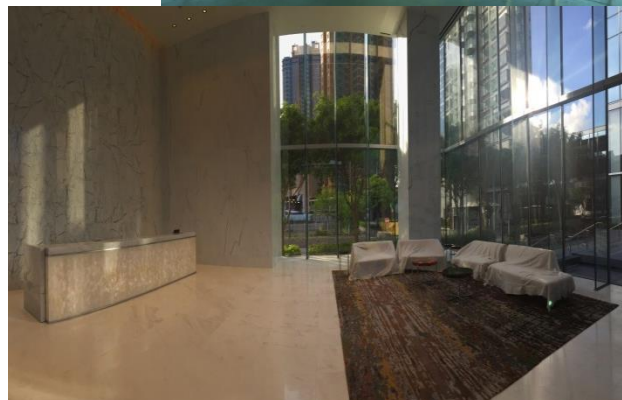

For any enquiries or viewing appointment,
please contact:
如有任何查詢或需預約視察物業，請聯絡代理：

Kowloon Office Leasing 九龍商業樓宇租務部
2378 8666

officekowloon@savills.com.hk

一切以合約為準 SUBJECT TO CONTRACT AND AVAILABILITY

SUBJECT TO CONTRACT: THIS DOCUMENT IS PREPARED BY SAVILLS FOR INFORMATION ONLY. WHILST REASONABLE CARE HAS BEEN EXERCISED IN PREPARING THIS DOCUMENT, IT IS SUBJECT TO CHANGE AND THESE PARTICULARS DO NOT CONSTITUTE, NOR CONSTITUTE PART OF, AN OFFER OR CONTRACT; INTERESTED PARTIES SHOULD NOT RELY ON THE STATEMENTS OR REPRESENTATIONS OF FACT BUT MUST SATISFY THEMSELVES BY INSPECTION OR OTHERWISE AS TO THE ACCURACY. NO PERSON IN THE EMPLOYMENT OF THE AGENT OR THE AGENT'S PRINCIPAL HAS ANY AUTHORITY TO MAKE ANY REPRESENTATIONS OR WARRANTIES WHATSOEVER IN RELATION TO THESE PARTICULARS AND SAVILLS CANNOT BE HELD RESPONSIBLE FOR ANY LIABILITY WHATSOEVER OR FOR ANY LOSS HOWSOEVER ARISING FROM OR IN RELIANCE UPON THE WHOLE OR ANY PART OF THE CONTENTS OF THIS DOCUMENT.

Prime Brand New Harbour View Office For Lease

優質全新維港景辦公室單位出租

Stock Ref. No. OLK20181203L - 10 December 2018

savills
第一太平戴維斯

savills.com.hk
Licence: C-002450

- ❖ Floor to ceiling approx. 3.05m to 3.35m clear
淨樓底高度3.05米至 3.35米
- ❖ 9.9m headroom entrance lobby with covered drop-off
9.9米華麗寫字樓大堂連上落客區
- ❖ 150mm raised floor system
150毫米架空地板
- ❖ Executive toilet with hot water supply provided for shower
行政洗手間設有熱水花灑提供
- ❖ Over 200 no. in-house car parking available
提供超過200個車位
- ❖ Fully integrated metal ceiling system
金屬天花飾照明裝置

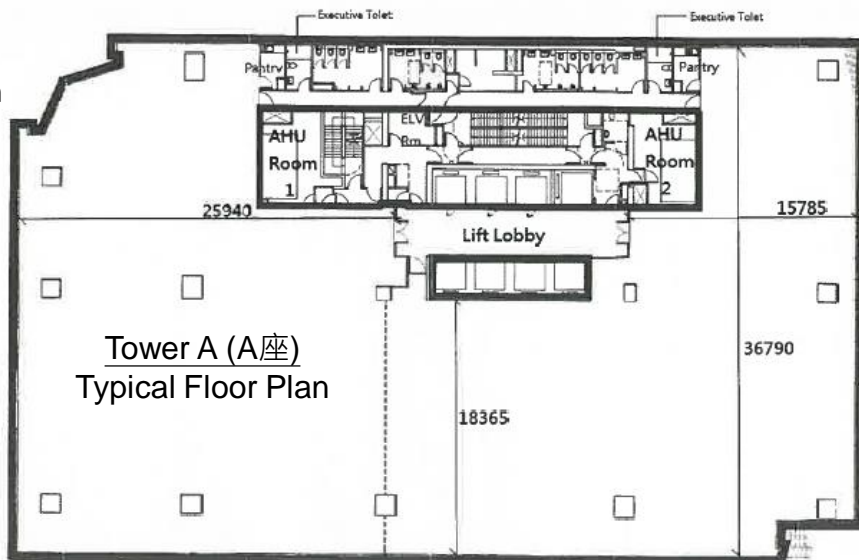

Floor Plan (for identification purpose only)



Location Map

For any enquiries or viewing appointment,
please contact:
如有任何查詢或需預約視察物業，請聯絡代理：

Kowloon Office Leasing 九龍商業樓宇租務部
2378 8666
officekowloon@savills.com.hk

一切以合約為準 SUBJECT TO CONTRACT AND AVAILABILITY

SUBJECT TO CONTRACT: THIS DOCUMENT IS PREPARED BY SAVILLS FOR INFORMATION ONLY. WHILST REASONABLE CARE HAS BEEN EXERCISED IN PREPARING THIS DOCUMENT, IT IS SUBJECT TO CHANGE AND THESE PARTICULARS DO NOT CONSTITUTE, NOR CONSTITUTE PART OF, AN OFFER OR CONTRACT; INTERESTED PARTIES SHOULD NOT RELY ON THE STATEMENTS OR REPRESENTATIONS OF FACT BUT MUST SATISFY THEMSELVES BY INSPECTION OR OTHERWISE AS TO THE ACCURACY. NO PERSON IN THE EMPLOYMENT OF THE AGENT OR THE AGENT'S PRINCIPAL HAS ANY AUTHORITY TO MAKE ANY REPRESENTATIONS OR WARRANTIES WHATSOEVER IN RELATION TO THESE PARTICULARS AND SAVILLS CANNOT BE HELD RESPONSIBLE FOR ANY LIABILITY WHATSOEVER OR FOR ANY LOSS HOWSOEVER ARISING FROM OR IN RELIANCE UPON THE WHOLE OR ANY PART OF THE CONTENTS OF THIS DOCUMENT.